



McGovern  
Medical School

The University of Texas  
Health Science Center at Houston



## Lyndon B. Johnson Hospital UTHealth Affiliated Harris Health Programs

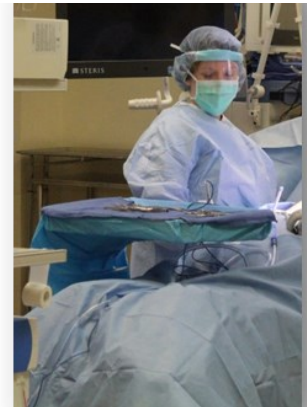

## Welcome Guide

- |                    |                                  |
|--------------------|----------------------------------|
| <b>CLINICIANS</b>  | high quality care for patients   |
| <b>RESEARCHERS</b> | discovery leading to innovation  |
| <b>EDUCATORS</b>   | next generation of professionals |
-

## LBJ HOSPITAL EXECUTIVE ADMINISTRATION



**Tien Ko, MD**  
*Chief of Staff*  
713.566.4646



**Derek Curtis, PhD**  
*Associate Administrator  
& Chief Nursing Officer*  
713.566.5700



**Chris Okezie, MBA, FACHE**  
*Associate Administrator*  
713.566.4480

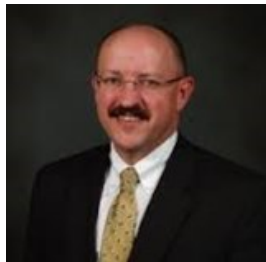

**Alan Vierling, PhD**  
*Sr. VP & Administrator*  
713.566.5103  
Assistant: Lorena Sanchez

## HARRIS HEALTH EXECUTIVE LEADERSHIP

**George V. Masi, FACHE**

President & CEO  
713.566.6100

Assistant: [Andrea.Kelley@harrishealth.org](mailto:Andrea.Kelley@harrishealth.org)

**Michael Norby**

EVP & Chief Financial Officer  
713.566.6790

Assistant: [Lourdes.ortega@harrishealth.org](mailto:Lourdes.ortega@harrishealth.org)

**Michael Gardner, MD**

EVP—ACS & Associate Administrator  
713.566.3828

Assistant: [Lourdes.Ortega@harrishealth.org](mailto:Lourdes.Ortega@harrishealth.org)

**Parikshet A. Babber, MD**

EVP & Chief Medical Office  
713.566.3810

Assistant: [Wanda.Detor@harrishealth.org](mailto:Wanda.Detor@harrishealth.org)

## EXEMPLARY CLINICAL SERVICES

Lyndon B. Johnson (LBJ) Hospital is part of the Harris Health System and is an acute care hospital offering a full range of medical services. LBJ Hospital is a verified **Level III** trauma center and is the state's busiest. Per day, there is an average of **240** emergency center visits, **200** outpatient visits, **33** admissions, **24** surgeries, and **8** deliveries.

Care is provided by **350** physician faculty and advanced practice providers from **McGovern Medical School** at the University of Texas Health Science Center at Houston (UTHealth) working closely with Harris Health partners. Oncological services are provided by our partners at UT MD Anderson Cancer Center.

### Service and Chief/Medical Directors

**Anesthesia** - Dr. Peter Doyle

**Dermatology** - Dr. Sarah Pinney

**Emergency Medicine** - Dr. Kumal Sharma

Trauma - Dr. Rondel Albarado

**Family Medicine** - Dr. Pedro Aquino

**Internal Medicine** - Dr. John Foringer

Cardiology - Dr. John Higgins

Endocrinology - Dr. Absalon Gutierrez

Gastroenterology - Dr. Sushovan Guha

Geriatric & Palliative Medicine - Dr. John Halphen

Hematology - Dr. Harinder Juneja

Infections Disease - Dr. Charles Ericsson

Pulmonary - Dr. Rosa Estrada-Y-Martin  
& Critical Care

Renal - Dr. Akinsansoye Dosekun

Oncology - Dr. Alyssa Rieber

General Internal Medicine

**Neurology** - Vacant

**OB/GYN** - Dr. John Riggs

GYN/Oncology - Dr. Lois Ramondetta

**Ophthalmology** - Dr. Megan Geloneck

**Oral & Maxillofacial** - Dr. Issa Hanna

**Orthopedics** - Dr. Allen Criswell

**Otorhinolaryngology** - Dr. Ibrahim Alava

**Pathology** - Dr. Robert Brown

**Pediatrics** - Dr. Jose Garcia

Neonatology - Dr. Sophia Tsakiri

Pediatric Surgery

**Physical Medicine & Rehabilitation** - Dr. Judy Thomas

**Psychiatry** - Dr. Luis Fernandez

**Radiology** - Dr. Joseph Hasapes

Interventional Radiology - Dr. Anil Pillai

**Surgery** - Dr. Tien Ko

Plastic - Dr. Daniel Freet

**Urology** - Dr. Melina McCarty

**Vascular & Thoracic Surgery** - Dr. Adel Irani

## HIGHEST QUALITY EDUCATION

Lyndon B. Johnson (LBJ) Hospital is a **major teaching hospital** for McGovern Medical School at UTHealth. One of the OB/GYN residency programs is based at LBJ Hospital and **all residents** from the twenty four medical school training programs rotate through the hospital.

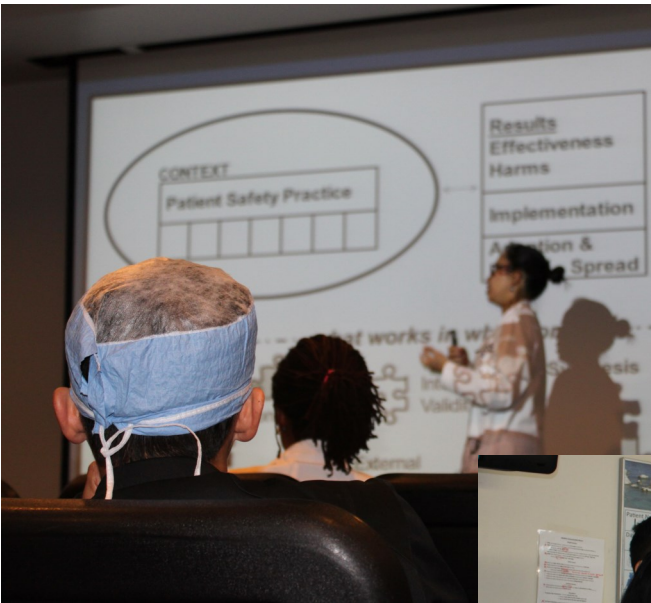

**250** fellows and residents per year and **100** medical students per month rotate through LBJ Hospital to gain **unparalleled knowledge** from skilled attending physicians.

## HIGHEST CALIBER OF RESEARCH

Over the past three years, physicians have initiated **63** projects at LBJ Hospital. The LBJ Clinical Research Unit has assisted investigators with the development of research and approval processes.



Two competitions are held each year, one for residents and one for faculty, that allow the physicians at LBJ Hospital to showcase the **quality initiatives** that they are implementing in order to improve patient care.

## AFFILIATED CLINICS

Faculty with McGovern Medical School at UTHealth additionally staff **14** community health centers. The majority of the providers in the clinics are **family medicine** practitioners but additional specialties are also available including OB/GYN, optometry, pediatrics and geriatrics.



Acres Home



Aldine



Bayland



Baytown

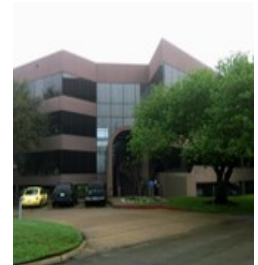

Bear Creek



Cleveland E. Odom



Danny Jackson



El Franco Lee



Long Branch



Margo Hilliard



Outpatient Center



Settegast

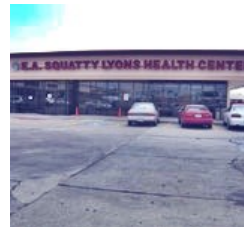

Squatty Lyons



Thomas Street

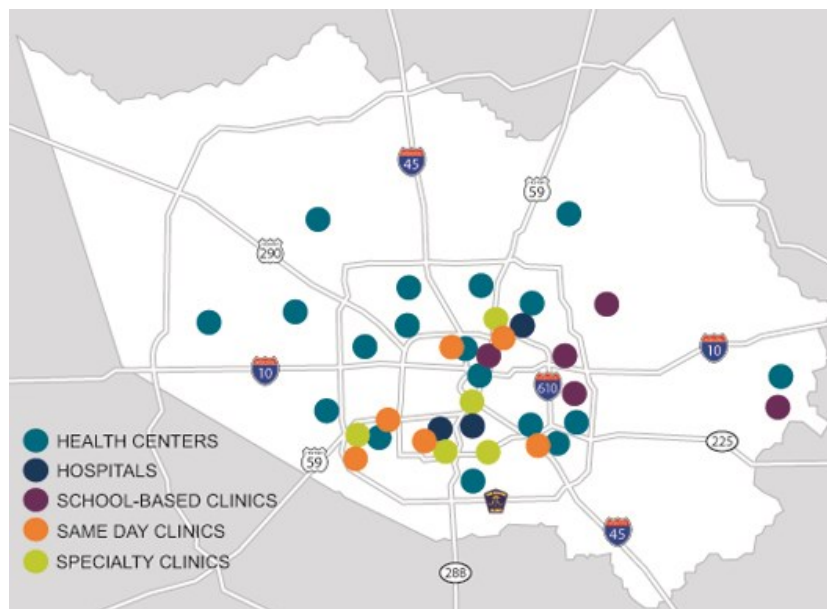

## HISTORY

In **1984**, The University of Texas Health Science Center at Houston (UTHealth) requested to staff the new Harris County hospital, the newly constructed **Lyndon B. Johnson Hospital**.



Since UTHealth clinicians and residents staffed LBJ Hospital in 1990, construction has been completed on a **new emergency department** in 2011 and a **specialty outpatient center** opened in 2013 on the campus.



**HARRISHEALTH  
SYSTEM**



# HOSPITAL FLOOR PLAN

## 1st Floor

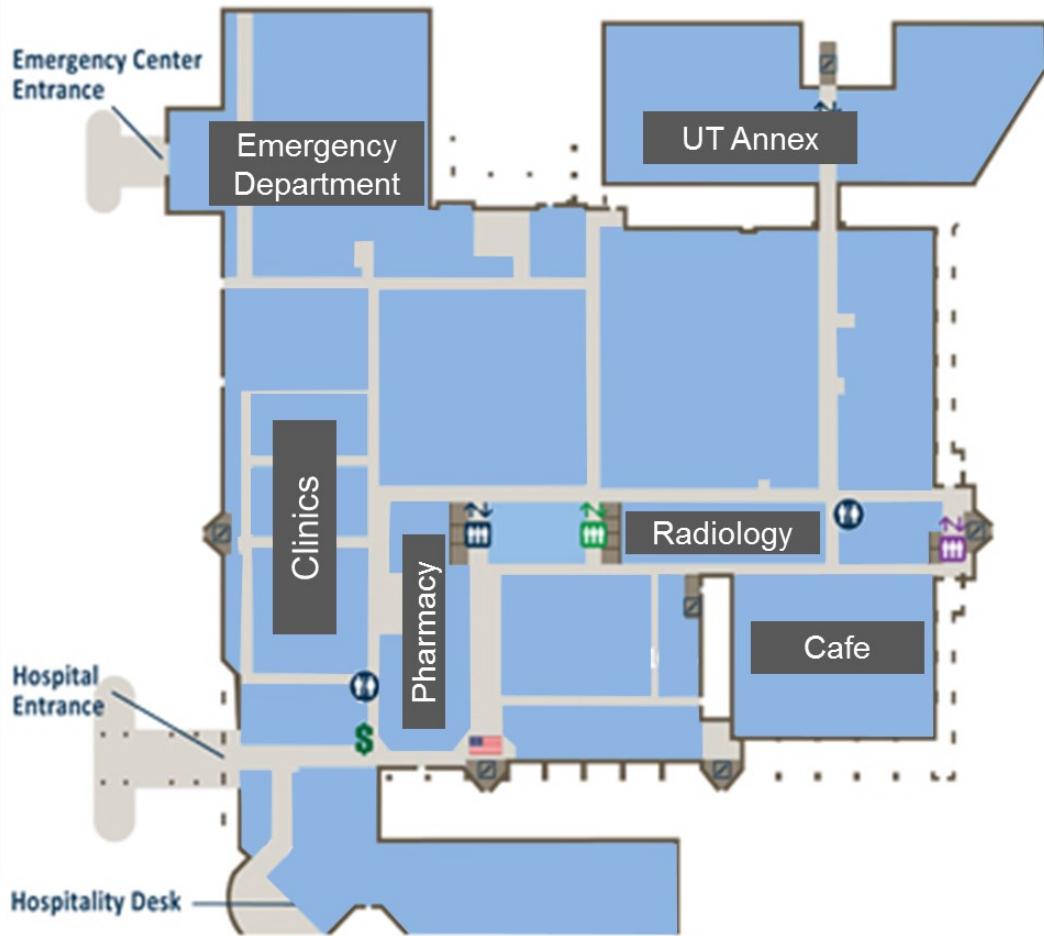

## 2nd Floor

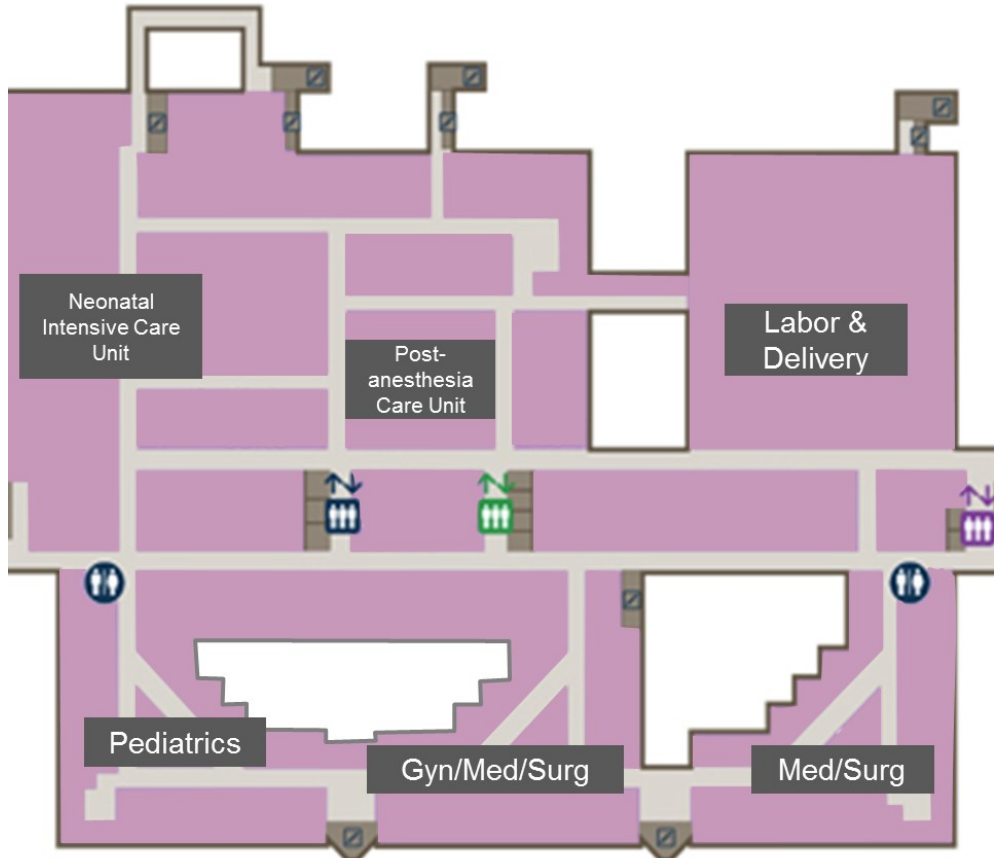



# HOSPITAL FLOOR PLAN

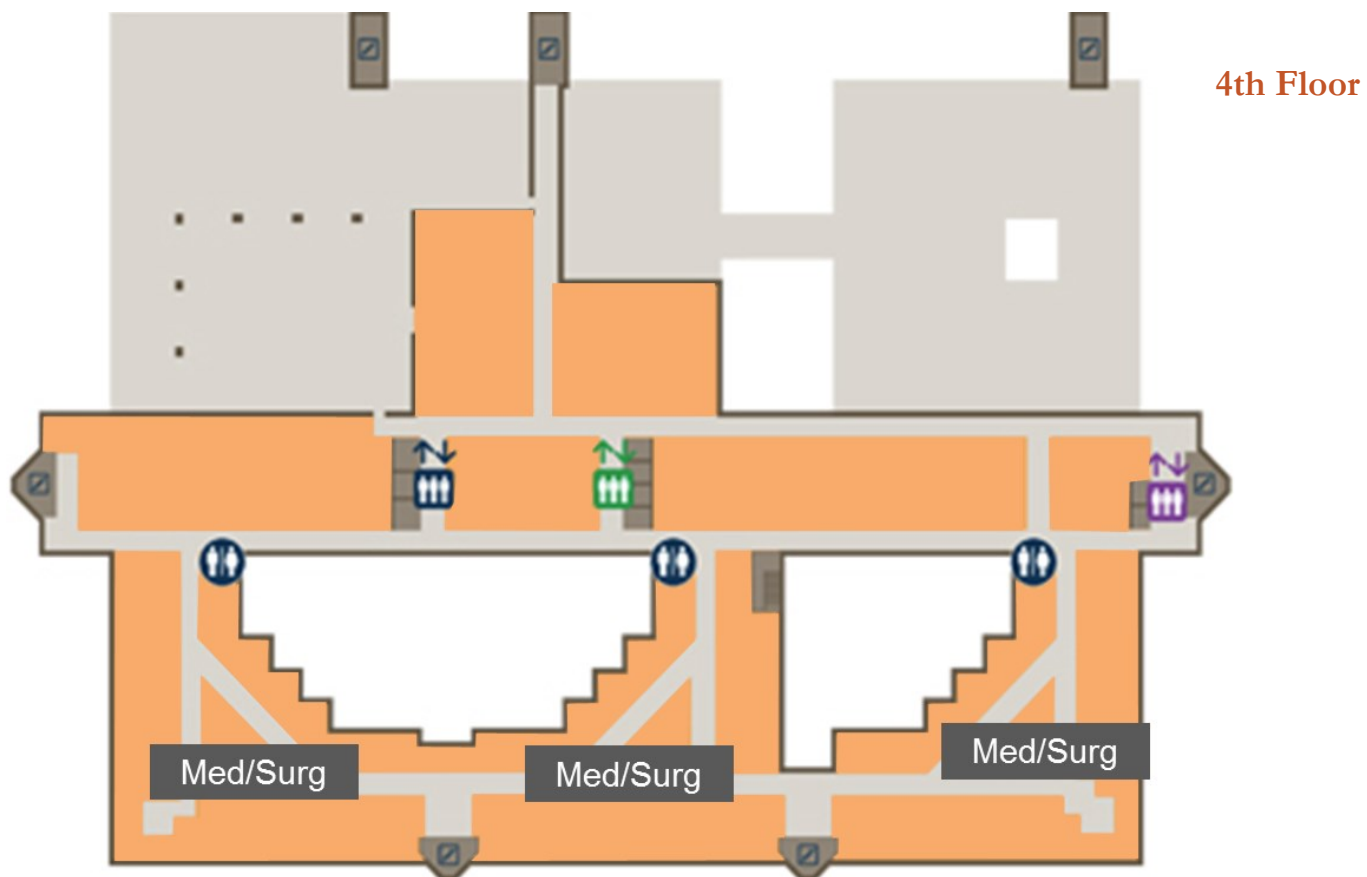
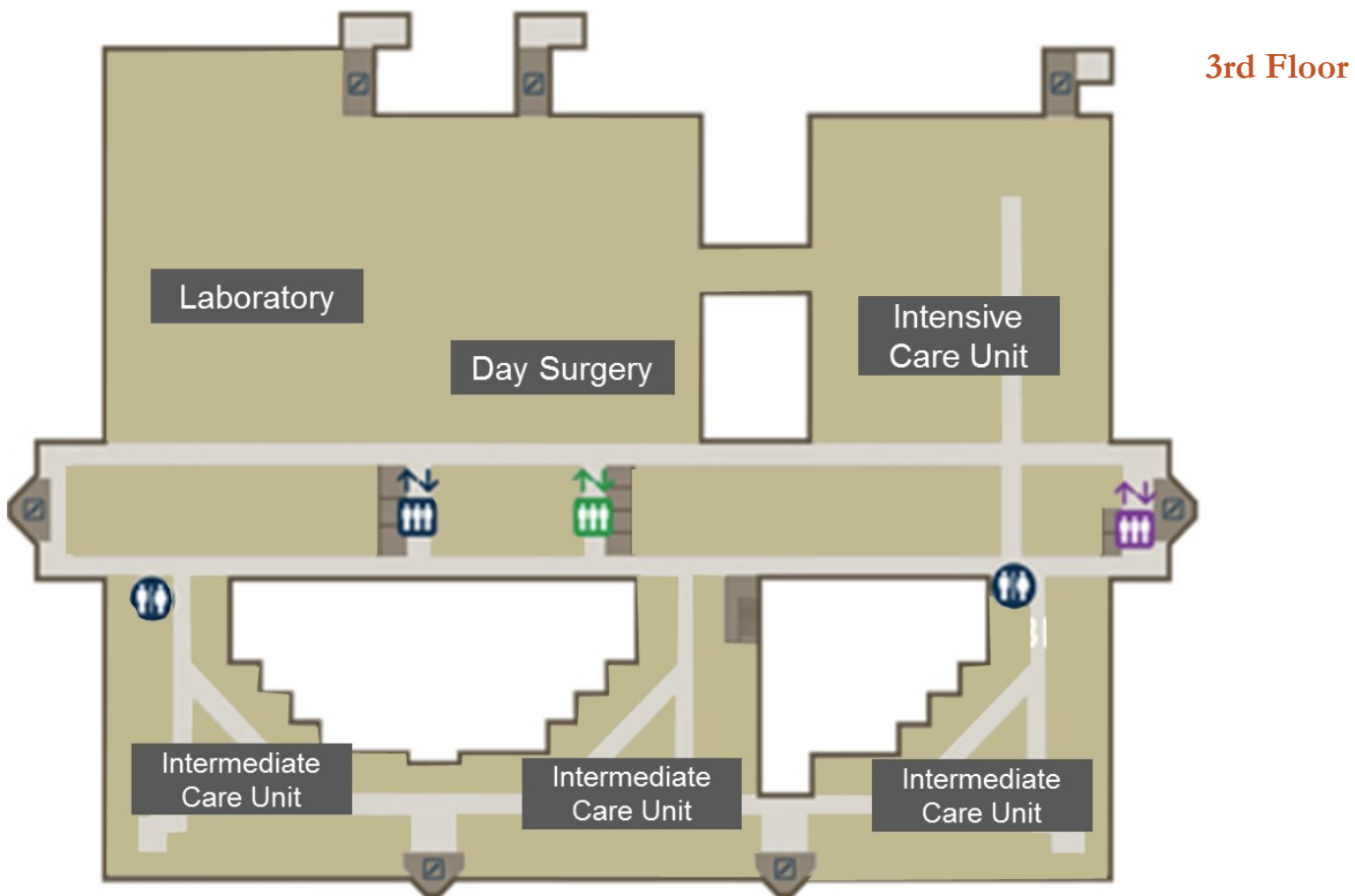

# OUTPATIENT CENTER FLOOR PLAN

## 1st Floor

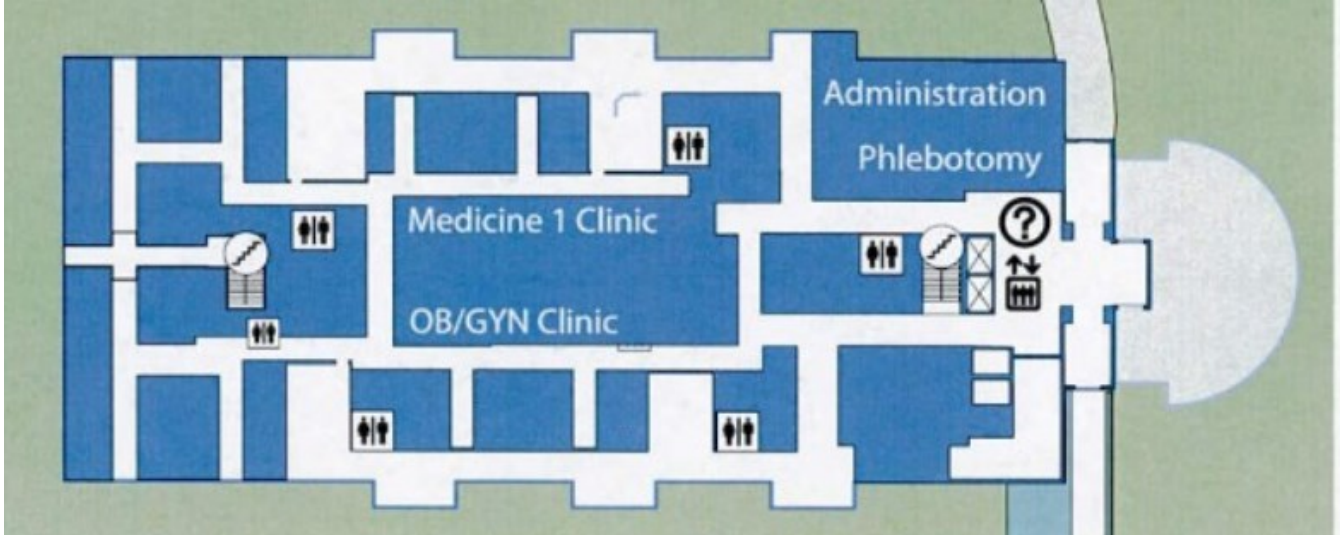

## 2nd Floor

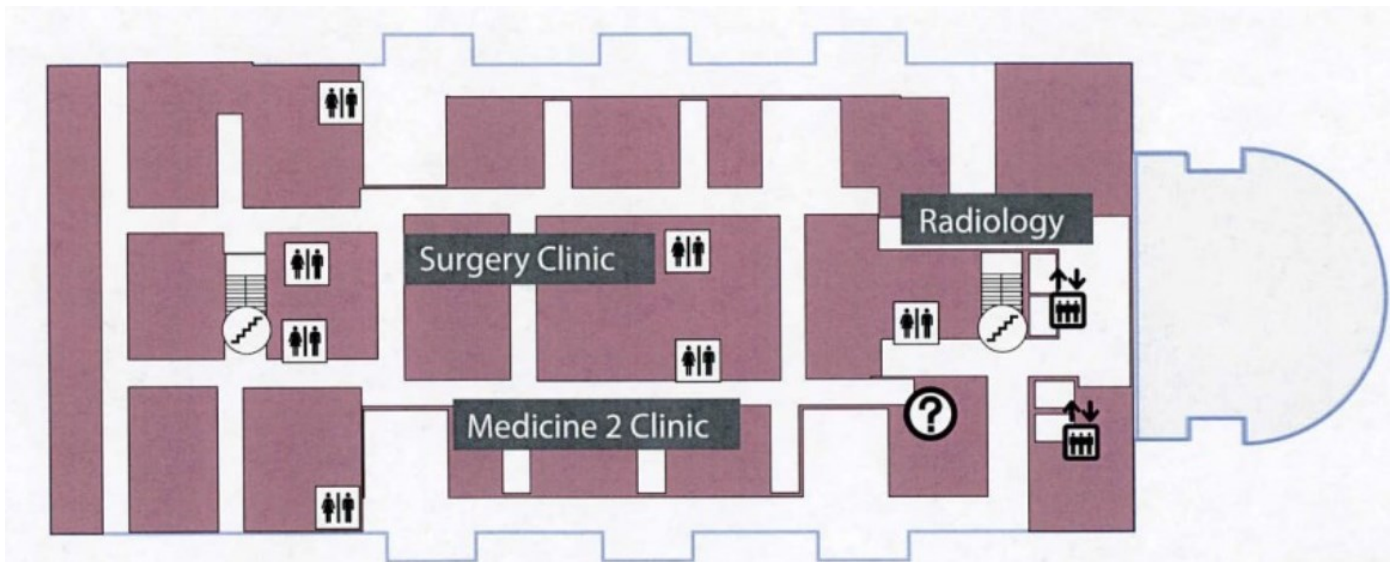

# AMBULATORY SURGERY CENTER // PARKING PLAN

## 3rd Floor

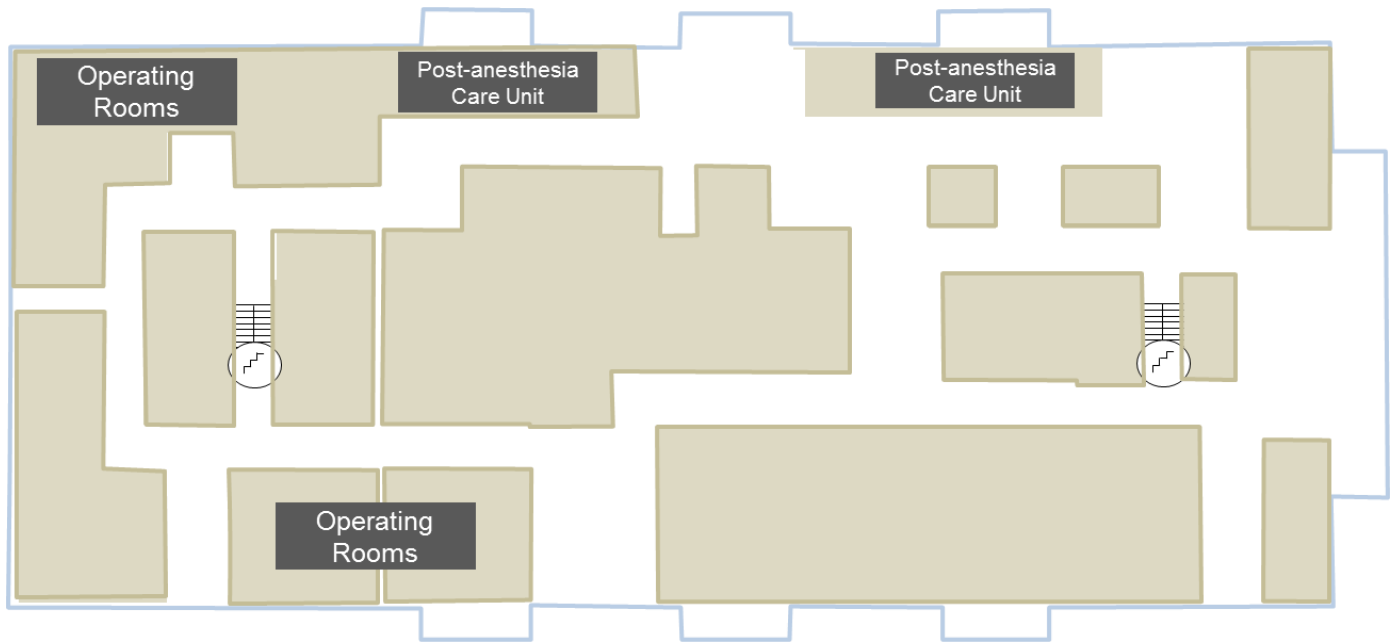

## Parking

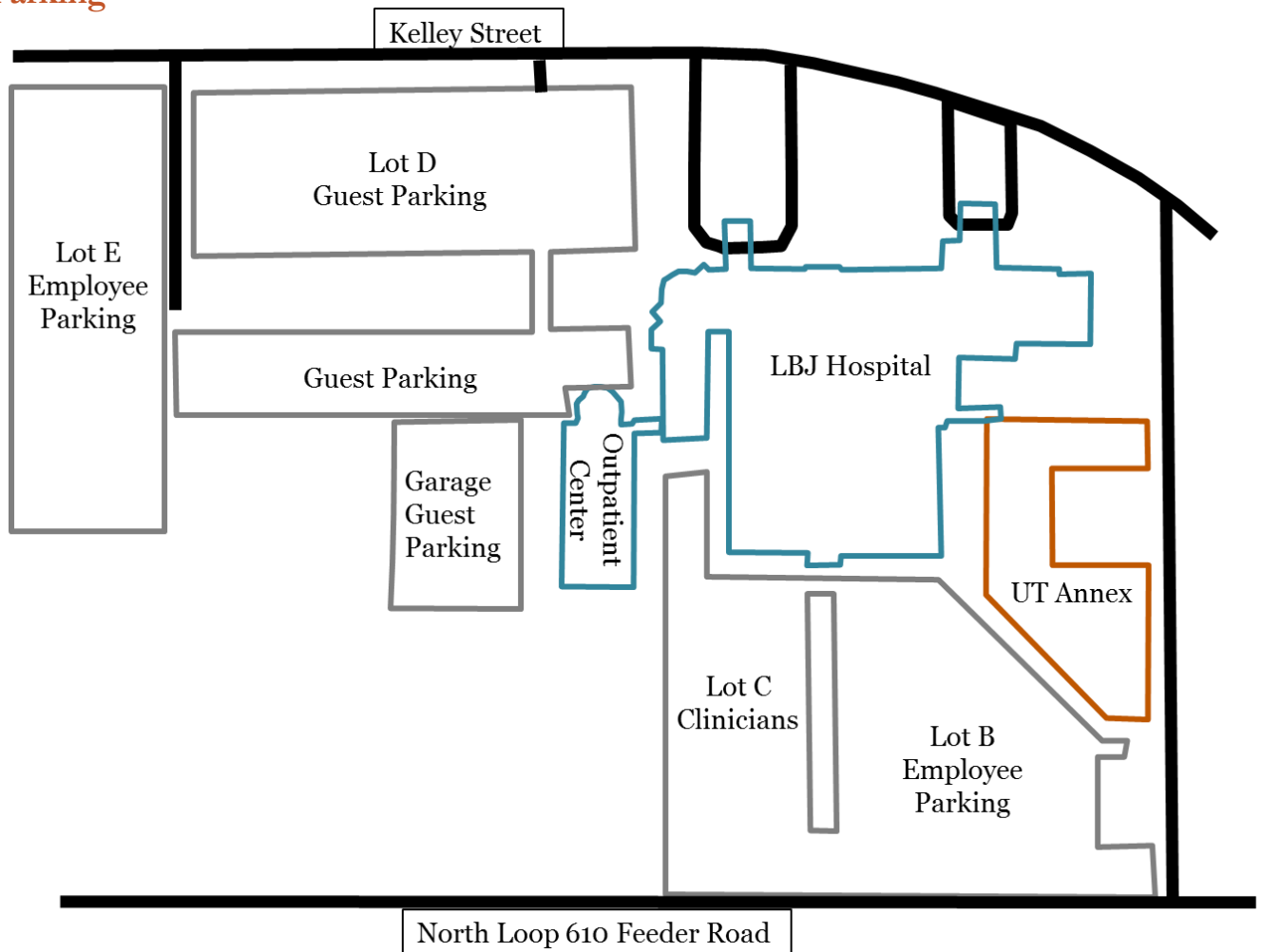

**Chief of Staff**

**Lyndon B. Johnson Hospital**

**1D 02 (Suite COS101)**

**5656 Kelley Street**

**Houston, TX 77026**

**Phone: 713.566.4646**

**Fax: 713.566.4655**

**<https://med.uth.edu/harrishealth/>**

**Email: [lbjchiefstaff@uth.tmc.edu](mailto:lbjchiefstaff@uth.tmc.edu)**



**UTHealth**<sup>TM</sup>

**The University of Texas**  
Health Science Center at Houston